

AIRCRAFT PARKING / DOCKING CHART - ICAO

AD 2 - EKAH
APDC
Aarhus

Changes : ATIS FREQ changed.

Apron ELEV : 69 FT

ACL ELEV : 69 FT

Aarhus TWR : 118.530
ATIS : 125.155

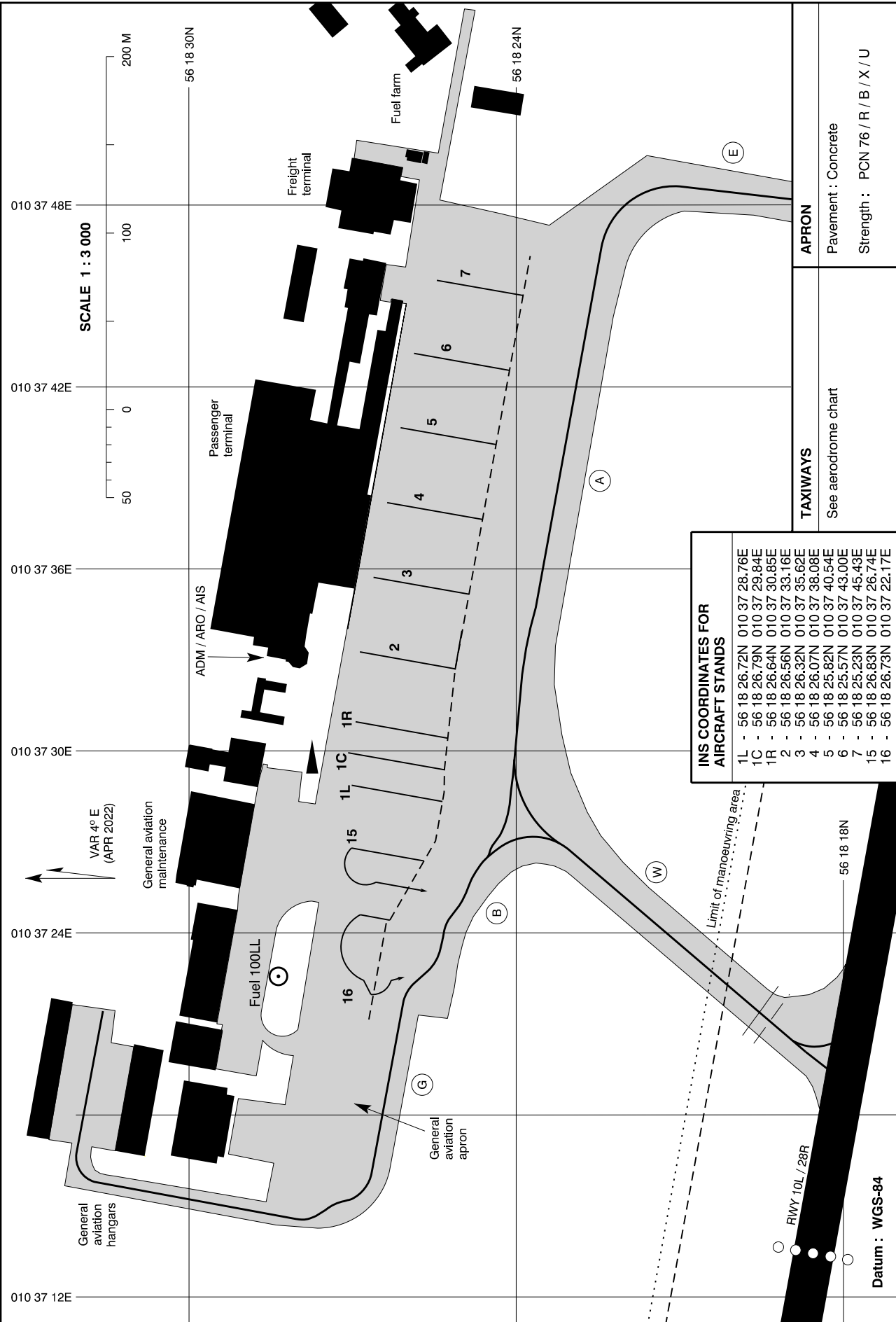

**INS COORDINATES FOR
AIRCRAFT STANDS**

1L	- 56 18 26.72N	010 37 28.76E
1C	- 56 18 26.79N	010 37 29.84E
1R	- 56 18 26.64N	010 37 30.85E
2	- 56 18 26.56N	010 37 33.16E
3	- 56 18 26.32N	010 37 35.62E
4	- 56 18 26.07N	010 37 38.08E
5	- 56 18 25.82N	010 37 40.54E
6	- 56 18 25.57N	010 37 43.00E
7	- 56 18 25.23N	010 37 45.43E
15	- 56 18 26.83N	010 37 26.74E
16	- 56 18 26.73N	010 37 22.17E

TAXIWAYS	APRON
See aerodrome chart	Pavement : Concrete
	Strength : PCN 76 / R / B / X / U

Datum : WGS-84